



Assisted Living Rate Sheet – 2022

1	Neighborhood	Accommodation	Daily	Monthly
	Orchard Terrace	Studio	\$168	\$5040
		1 Bedroom	\$177	\$5310
		Companion Suite (shared Bath)	\$158	\$4740
		Deluxe 1 BR/ Couple's Suite	\$198	\$5940
	Fiddler's Green	Studio	\$168	\$5040
		1 Bedroom	\$177	\$5310
		2 Bedroom	\$194	\$5820
Above: 2nd Person in same suite – the cost for the 2nd person is \$1500/month, plus level of care.				
Below: Garden House & Blossom Place are specialized Memory Care Assisted Living				
	Garden House	Studio Only	\$158	\$4740
	Blossom Place	Studio Only with Private Bath	\$168	\$5040

2	Care Levels	Daily	Monthly
	Level 1	\$30	\$900
	Level 2	\$40	\$1200
	Level 3	\$50	\$1500
<p>Care levels are determined, in part, by completion of 1) Health Care Practitioner Physical Assessment by the resident's physician; 2) Nursing Assessment by our Delegating RN; and 3) Maryland State Assisted Living Scoring Tool, all of which consider factors such as mobility, medications, monitoring of clinical needs, safety awareness, fall risk, incontinence, and cognitive and behavioral status.</p>			

How to Calculate Costs 1) Accommodation Rate + 2) Care Level = Total Cost

What's included in the Cost? Room, all meals and snacks, housekeeping, personal laundry, linens, towels, activities program, basic cable, wi-fi, and furniture – bed, dresser, nightstand, chair, lamp (or resident can bring his/her own furniture); & personal care such as assistance with bathing, dressing, toileting, mobility, medication administration, individual care plans, monitoring of clinical status and needs.

One-time, non-refundable Community Fee of \$3000 (\$4000/couple)

***30-day respite stays based on availability – Add \$10/day**

Prices effective as of 1/1/2022 and are subject to change without notice
Costs listed above reflect a 30 day month

5800 Genesis Lane
Frederick, MD 21703

Phone: 301-694-3100
Fax: 301-694-0308



Floor Plans for Assisted Living : Orchard Terrace

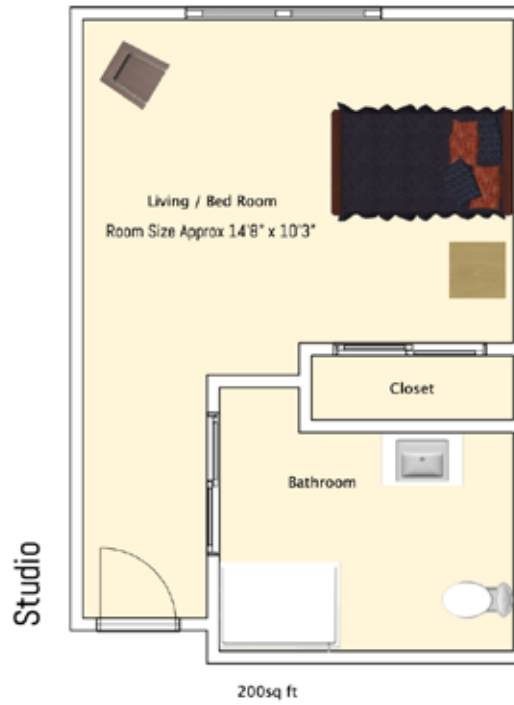

Floor Plans for Assisted Living : Orchard Terrace



Floor Plans for Assisted Living : Fiddler's Green

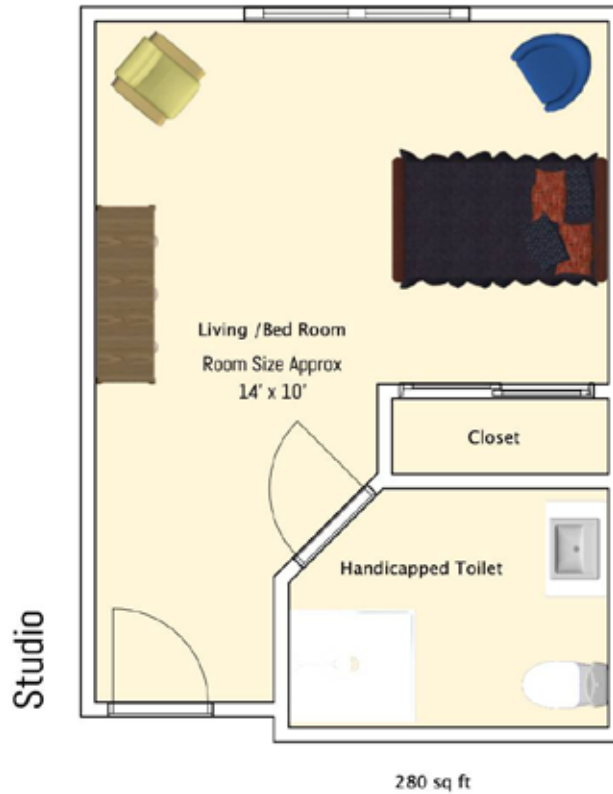

Floor Plans for Assisted Living : Fiddler's Green

